

# Chrome OS Print Driver User Manual

Version 0.2.0 (2023.08.24)

POS Printer manager is a printer driver customized specifically for Chrome OS, supporting all USB, Bluetooth, WebSocket network protocol communication for receipt and label printers. It can be deployed on laptops running Chrome OS, also can be deployed as a browser extension on browsers based on the Chromium kernel, such as Chrome browser and Microsoft Edge browser.

## 1. Install Driver

Open the browser menu, select "More Tools," then choose "Extensions." On the Extensions page, enable the Developer mode by toggling the switch in the upper-right corner. Next, click on the "Load unpacked" button in the upper-left corner. Navigate to the folder where you've already extracted the extension files. Once done, you will see the installed POS Printer Manager extension listed on the page.

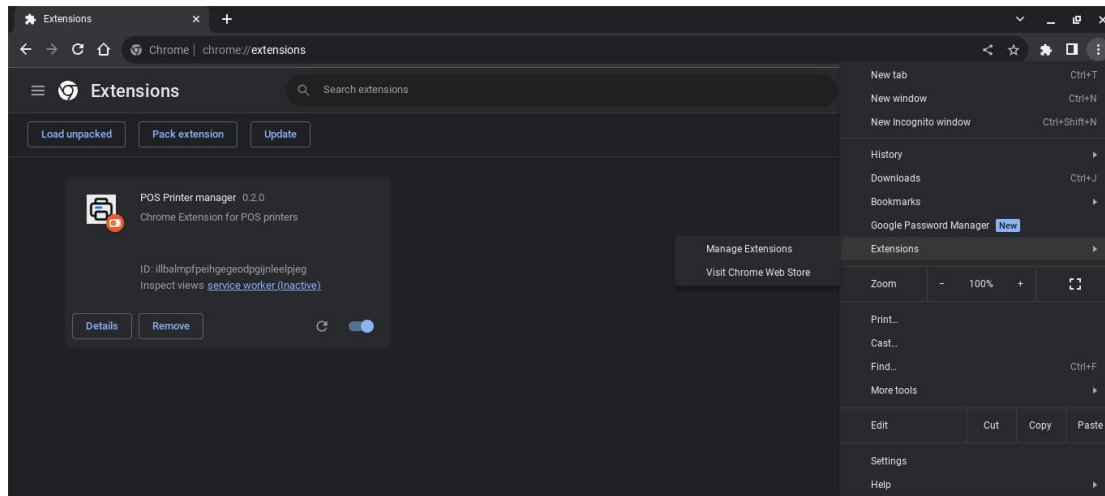

## 2. Connect Printer

In the Chrome browser, click on the "Extensions" icon located in the upper-right corner. From there, select the installed print plugin to navigate to the POS Printer Manager page. On this page, you'll have the option to connect your printer using three different methods.

## 2.1 USB Connection

Click on "USB" and connect the receipt or label printer to the Chromebook using a USB connection. Click "Connect" to open a window displaying available printer devices. Select the printer you want to connect to, and then click "Connect" again. If the connection is successful, the middle of the page will display "Paired device: [selected printer model]."

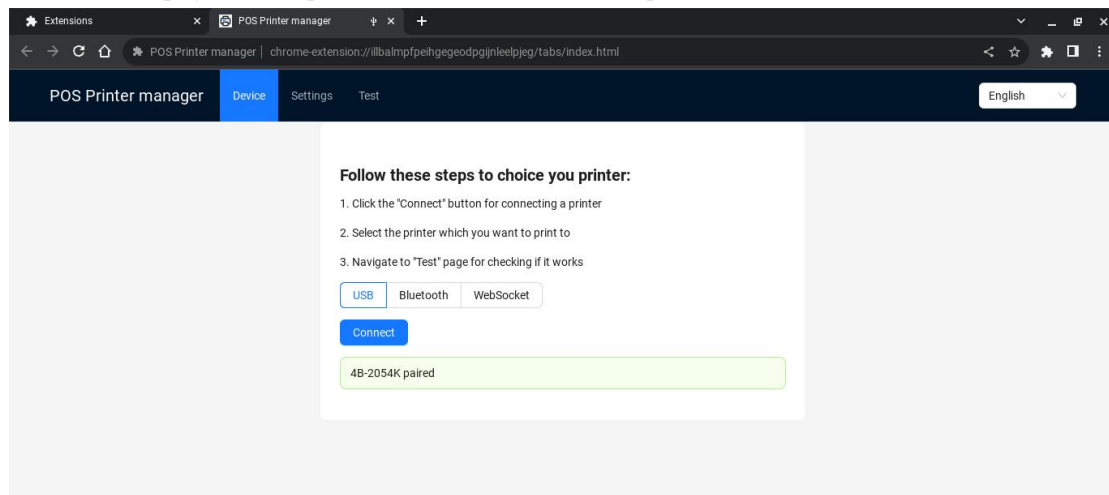

## 2.2 Bluetooth Connection

Click on "Bluetooth," enable the Bluetooth communication module on the receipt or label printer, and then click "Connect." A window will appear displaying the detected Bluetooth printer devices. Select the printer you want to pair with and click "Connect" once again. If the connection is successful, the middle of the page will show "Paired device: [selected printer model]."

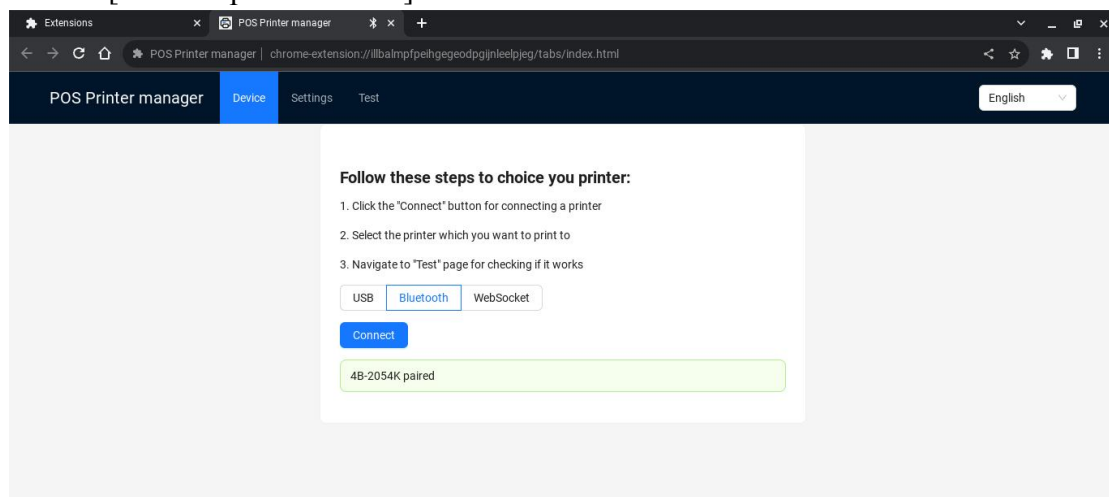

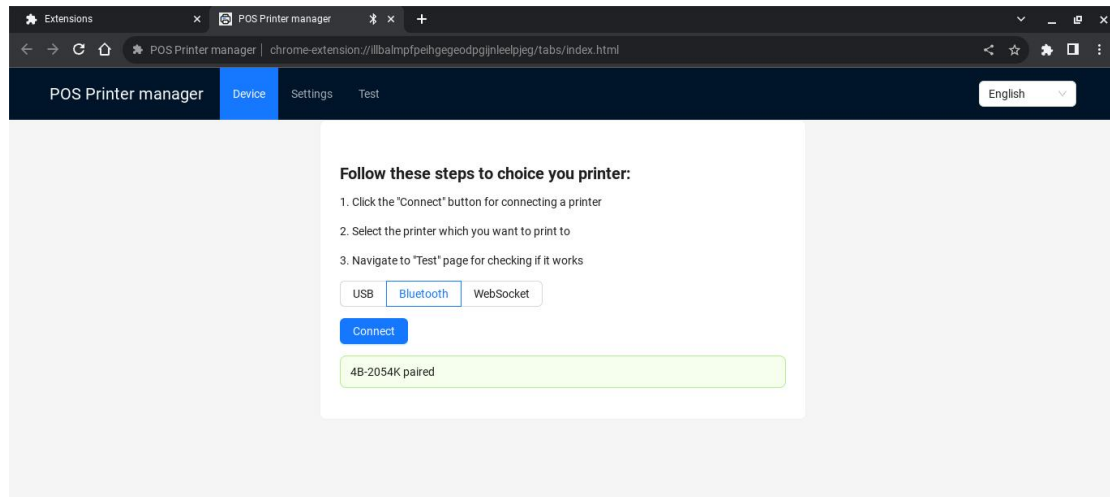

## 2.3 WebSocket Connection

If using WebSocket connection, please ensure that the printer and the operating device are connected to the same router. Print a self-test page and find the WiFi address on it. Click on "WebSocket Configuration" to view the web port number, Go back to the connection page and click on "WebSocket Connection." Input the IP address from the self-test page and the port number from the previous step. Once successfully connected, you should be all set.

If you don't have a WebSocket option, it means WebSocket connection is not supported.

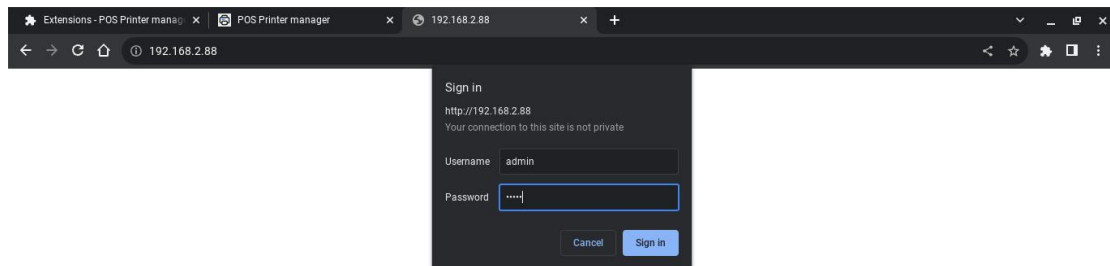

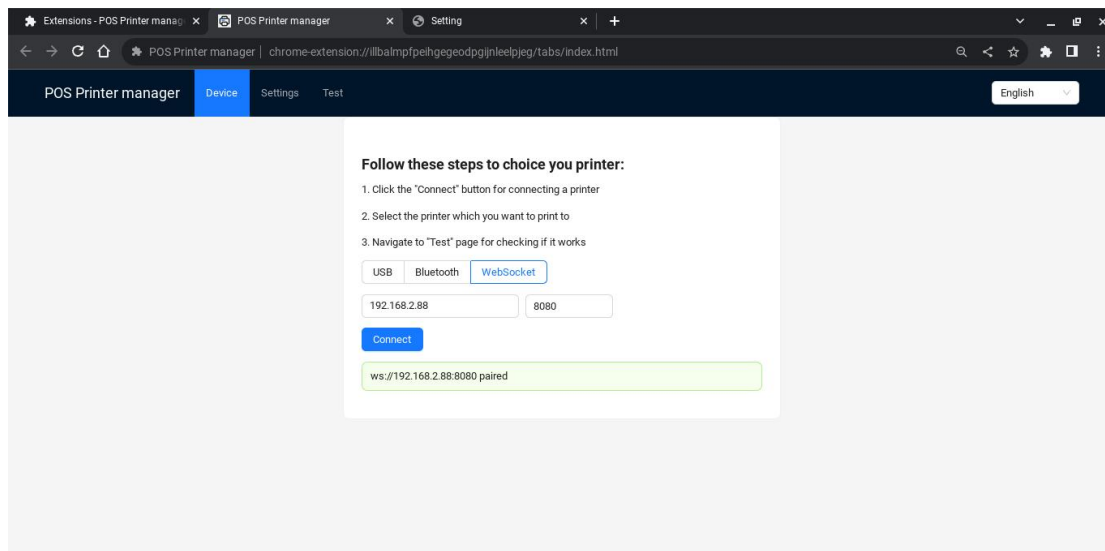
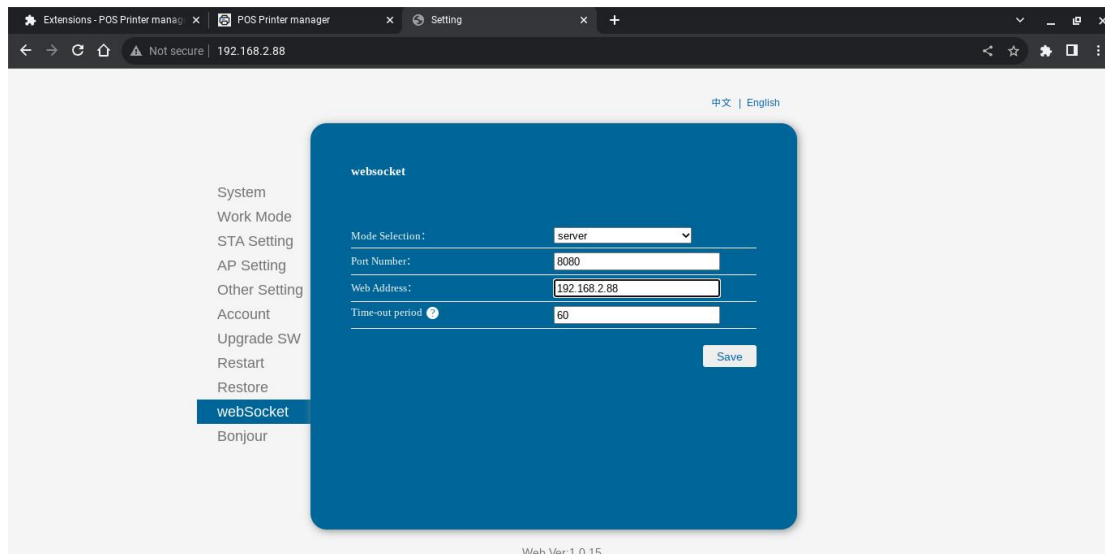

### 3. Printer Parameter Settings

Currently, the POS Printer Manager printer driver supports both receipt and label printers. When using a receipt printer, go to the printer management page and click on "Setting." Then, click the dropdown menu under "Command Type" and select "ESC/POS." If you're using a label printer, please choose "TSPL." After configuring the parameters, make sure to click the "Save" button to save your settings. Below is an explanation of the printer parameter settings for "ESC/POS" and "TSPL."

#### 3.1 ESC/POS

Density: Use Printer Current Settings, ranging from 1 to 8.

Halftone: Disable, Error Diffusion.

Cut Paper: Disable,Cut paper per page,Cut paper per job.

Open Cash Drawer: Disable,Open Cash Drawer Before Print, Open Cash Drawer After Print.

Paper Saving: Disable,Top,Bottom,Top&Bottom.

Compress: ON,OFF (Note: Please disable this feature for receipt printers without compression algorithms, as enabling it may result in printing gibberish characters.)

Custom Paper Size: During printing, the "CUSTOM" option in the paper size settings refers to the dimensions set for this specific custom paper size.

Log: Enable, Disable Print Code Logging.

Note: After modifying parameters, make sure to click "Save" for the changes to take effect.

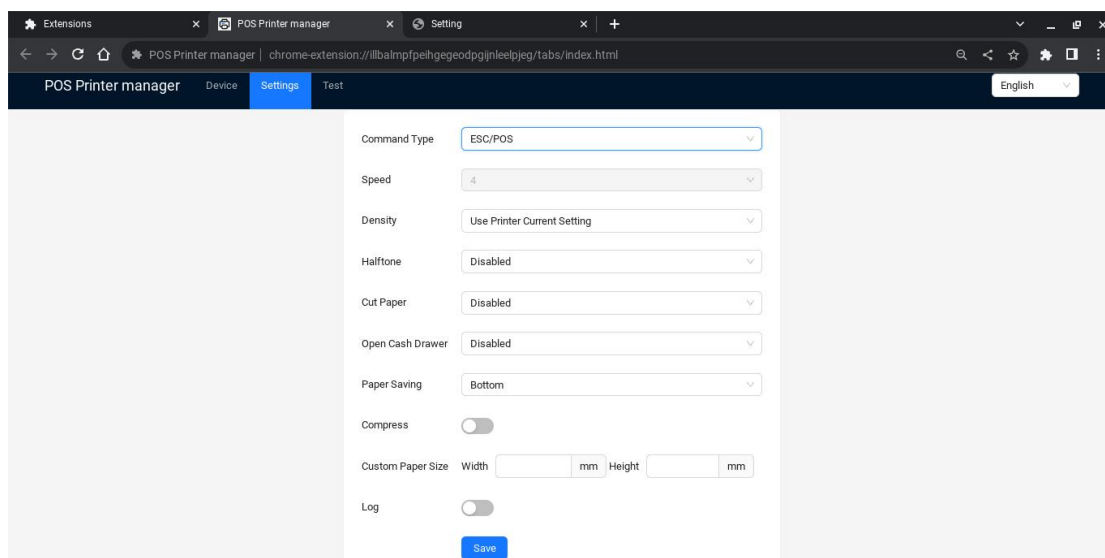

### 3.2 TSPL

Speed: Use Printer Current Settings, ranging from 1 to 8.

Density: Use Printer Current Settings, ranging from 1 to 8.

Halftone: Disable, Error Diffusion.

Custom Paper Size: During printing, the "CUSTOM" option in the paper size settings refers to the dimensions set for this specific custom paper size.

Log: Enable, Disable Print Code Logging.

Note: After modifying parameters, make sure to click "Save" for the changes to take effect.

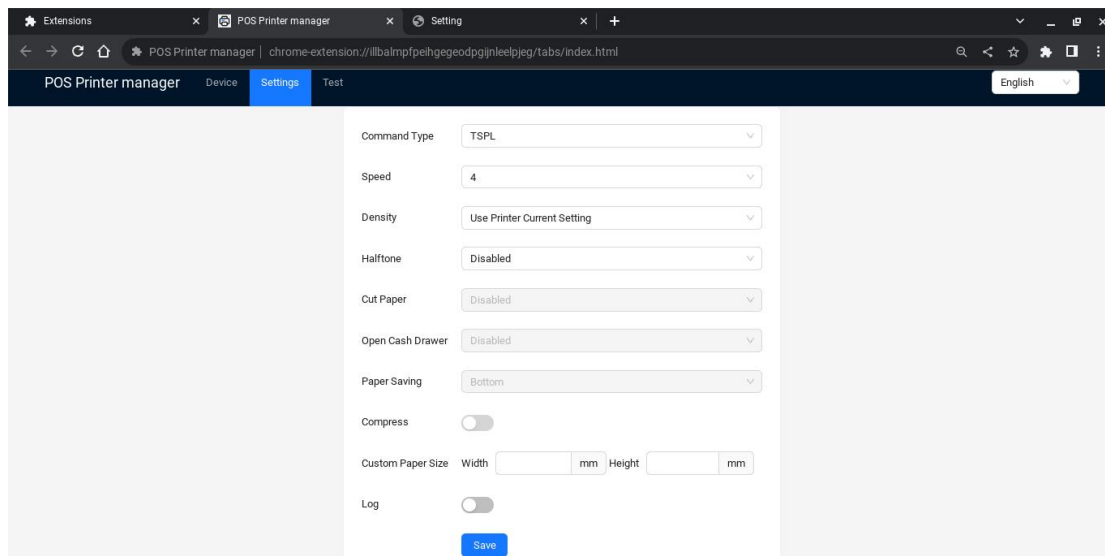

## 4. Commands

When the "Command Type" is set to "TSPL" on the Setting page, clicking "Test" on the printer management page will open the testing page. Input the correct commands (TSPL2, ZPL), and then click the blue "Send" icon below. This action will initiate a test printing operation on the printer. The commands sent will also modify the default printer settings, including gap paper detection, paper gap , print orientation, and more.

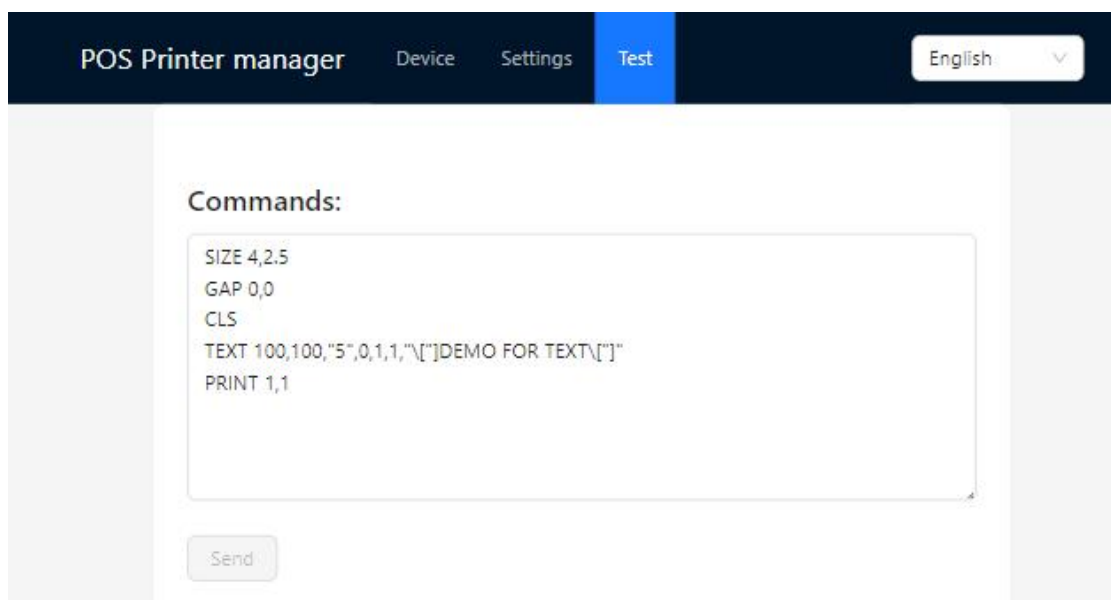

## 5 Logs

When the logging option is enabled on the settings page, a new "Log" page will be added to the navigation bar. After each printing job is executed, this page will store a record of the print code used. To view these logs, locate the desired log and download it to a path of your choice.

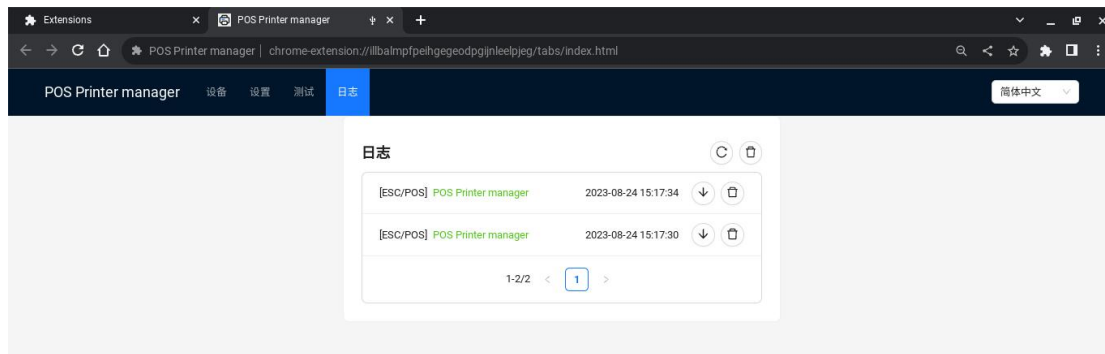

## 6 Print Content

When you're on the page you want to print, click the print button to proceed to the print preview page. Before initiating the printing job, ensure you follow these three steps:

1. Select Printer: Choose a printer from the "Device" page in the Printer Management section. This printer should be one that has been successfully connected and matched.
2. Choose Paper Size: Select the appropriate paper size. For the "CUSTOM" option, refer to the custom paper size set in the "Setting" page of Printer Management.
3. Print Quality: Confirm the actual resolution of the printer, whether it's 203 DPI or 300 DPI. In the print quality dropdown, select the corresponding resolution.

After confirming these three points, you can proceed with your printing job.

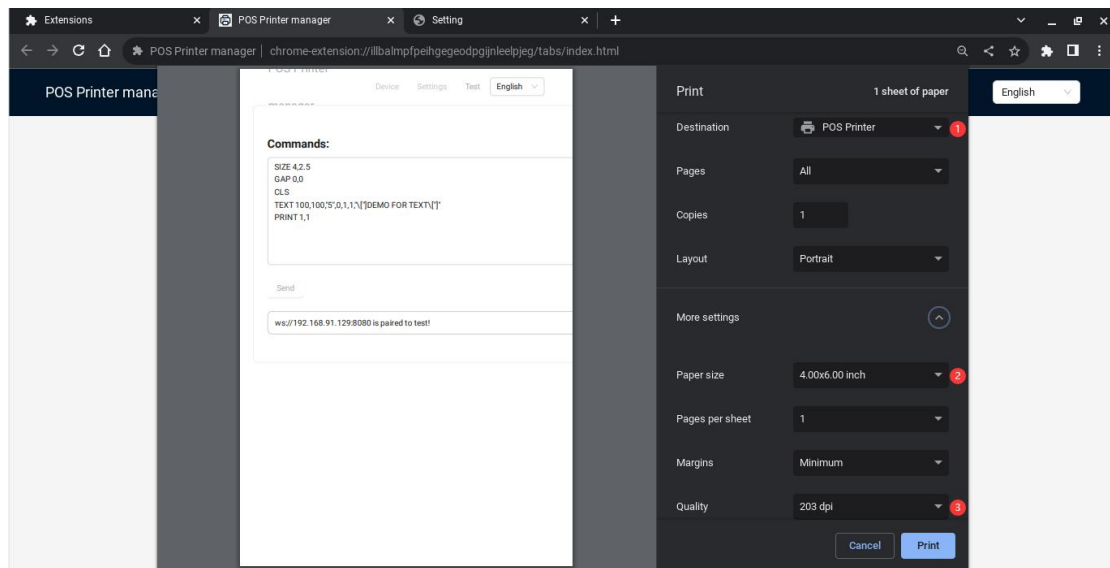

## 7 Uninstall Driver

Open the extensions page, click "Remove" below the plugin, then click "Remove" again in the top-right corner popup to delete the driver.

